



### Snake Trunk

**12 C30 - E3**

**Ch. count**  
8, 12, 16,  
24, 32

**Cable length**  
C10=10m  
C30=30m  
C50=50m

**Type of multichannel cable**  
E3=L-4E3 series  
M2=M202 series

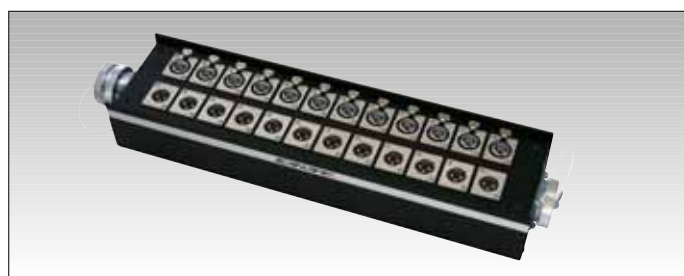

### Junction Box

**12 J12 N 12 (F77)**

**Ch. count**  
8, 12, 16, 24, 32

#### Cannon connectors

B1=female only  
B2=male only  
J12=male, female, parallel wired

**Multichannel connector format**

1=female  
2=male

12=female and male

**Type of multichannel connectors**

N=NK type, F=FK type  
MS=MS type

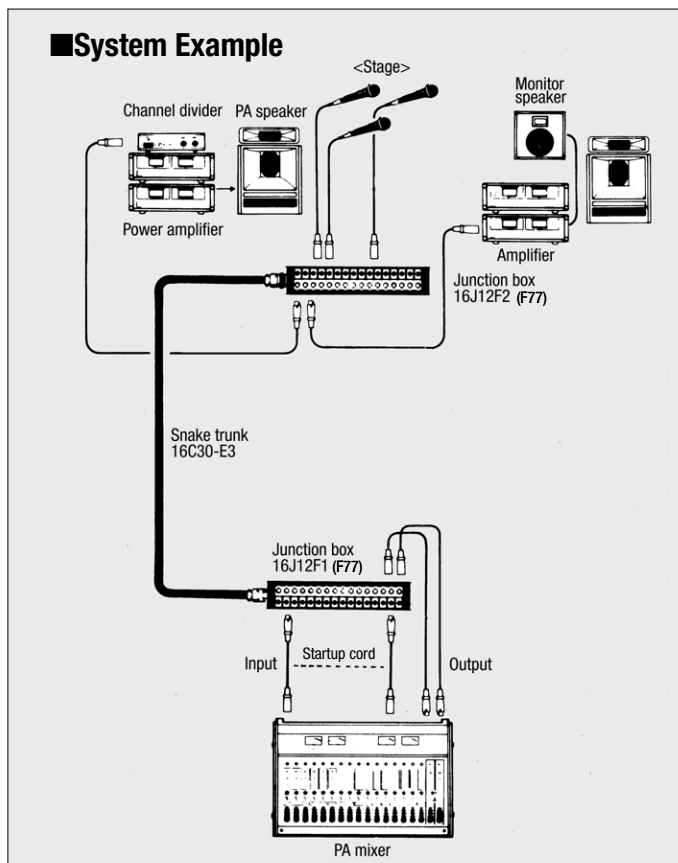

### Fantail

**12 S2 N 1**

**Ch. count**  
8, 12, 16,  
24, 32

**Cannon connectors**  
S1=female  
S2=male

**Multichannel connector**  
1=female  
2=male

**Type of multichannel connectors**  
N=NK type  
F=FK type  
MS=MS type



### Cable Reel Snake

**12 R30 - E3 (F77)**

**Ch. count**  
8, 12, 16, 24,

**Cable length**  
R30=30m  
R50=50m

**Type of cable**  
E3=L-4E3 series  
•Panel contains both male and female XLR connectors parallel wired

### Connectors Used With Canare Multichannel Cable Systems

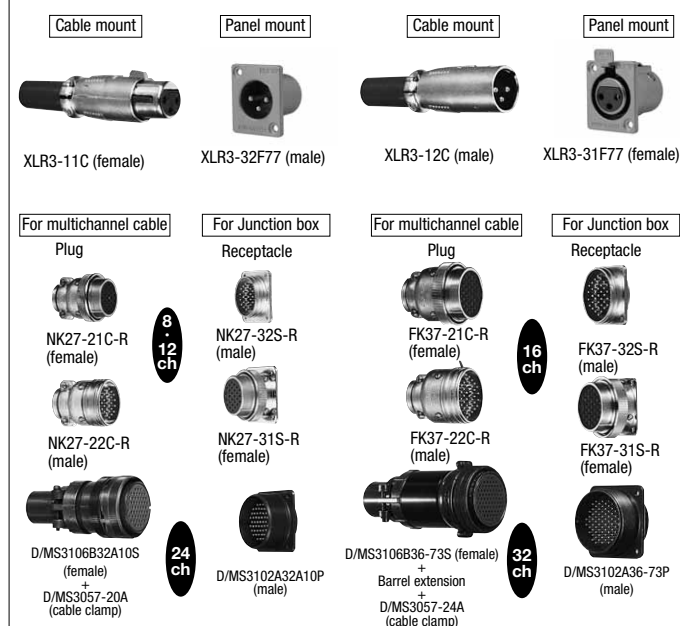

## Multichannel Connector Pin Assignments

Ch No.	Cable Unit Identification			32ch		24ch		16ch		8ch + 12ch	
	L-4E3	M202		D/MS3102A36-73 D/MS3106B36-73		D/MS3102A32A-10 D/MS3106B32A-10		FK37		NK27	
	Spiral Marker Color	Insulator Color		HOT	COLD	HOT	COLD	HOT	COLD	HOT	COLD
		Identifying Color	Common Identifying Color								
1	RED	RED	• WHT	A	B	A	B	1	2	1	3
2	BLU	BLU	•	C	D	C	D	3	4	4	5
3	YEL	YEL	•	F	H	F	G	5	6	6	7
4	GRN	GRN	•	J	K	H	J	8	9	8	9
5	BRN	BRN	•	L	M	K	L	10	11	11	12
6	N/A	GRY	•	N	P	N	O	12	13	13	14
7	BLU • BLK	BLU	• BLK	R	S	P	R	14	15	15	16
8	YEL • BLK	YEL	•	T	U	S	T	16	17	17	18
9	GRN • BLK	GRN	•	V	W	U	V	21	22	19	20
10	BRN • BLK	BRN	•	Y	Z	X	Y	23	24	22	23
11	BLK	GRY	•	a	b	Z	a	25	26	24	25
12	BLU • ORN	BLU	• ORN	c	d	b	c	27	28	26	27
13	YEL • ORN	YEL	•	f	g	d	e	29	30	SHIELD	
14	GRN • ORN	GRN	•	h	i	g	h	32	33	10	
15	BRN • ORN	BRN	•	j	k	j	k	34	35		
16	ORN	GRY	•	m	n	m	n	36	37		
17	BLU • PNK	BLU	• PNK	u	v	p	q	SHIELD			
18	YEL • PNK	YEL	•	w	x	s	t	19			
19	GRN • PNK	GRN	•	y	z	u	v				
20	BRN • PNK	BRN	•	AA	AB	w	x				
21	PNK	GRY	•	AC	AD	AB	z				
22	BLU • WHT	BLU	• RED	AE	AF	AA	AC				
23	YEL • WHT	YEL	•	AH	AJ	AD	AF				
24	GRN • WHT	GRN	•	AL	AM	AG	AE				
25	-	BRN	•	AN	AP	SHIELD					
26	-	GRY	•	AR	AS	E					
27	-	YEL	• BLU	AT	AU						
28	-	GRN	•	AV	AW						
29	-	BRN	•	AX	AY						
30	-	GRN	• YEL	AZ	BA						
31	-	BRN	•	BC	BD						
32	-	GRY	•	BE	BF						
				SHIELD							
				E	q	t					
				X	r	AK					
				p	s	BB					

■ Connection Me

L-4E3 Types:  
Identify the channel  
on the inner jacket by  
the insulator colors  
these with the same  
connected to Hot or

M202 Types:  
The unit is 2-core c  
(a combination of th  
fying color core to H

■ Connections to

32ch

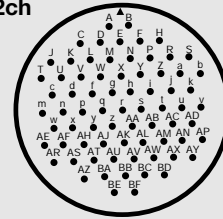

24ch

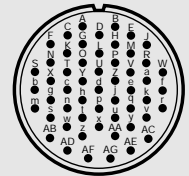

16ch

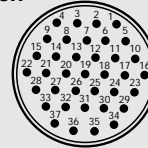

8 • 12ch

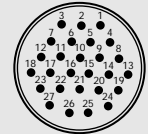

### ■ Connection Method

#### L-4E3 Types:

Identify the channel number by the color of the spiral marker on the inner jacket (gray). The unit is 4-core construction and the insulator colors are blue, blue, white, and white. Connect these with the same colored cores, so that the blue cores are connected to Hot and the white cores to Cold.

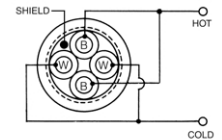

#### M202 Types:

The unit is 2-core construction, with the channel number identified by the insulator color (a combination of the identifying color and common identifying color). Connect the identifying color core to Hot, and the common identifying color core to Cold.

### ■ Connections to XLR Connectors

Polarity	HOT	COLD	SHIELD
Pin No.	2	3	1